

EDELSTAHL - Schneckengetriebe

Full stainless steel worm gearboxes

This range is

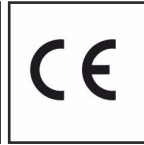

certified



EDELSTAHL - Schneckengetriebe

Full stainless steel worm gearboxes

Type <i>Tipo</i>	Torque <i>Coppia</i>	Center distance <i>Interasse</i>	Input power <i>Potenza in entrata</i>	Hollow output shaft <i>Albero cavo in uscita</i>
I30	21 Nm	30 mm	0.06 ÷ 0.18 kW	ø14 mm
I45	41 Nm	45 mm	0.12 ÷ 0.37 kW	ø18 mm ø19 mm
I50	72 Nm	50 mm	0.12 ÷ 0.75 kW	ø25 mm ø24 mm
I63	147 Nm	63 mm	0.37 ÷ 1.8 kW	ø25 mm ø28 mm
I85	347 Nm	85 mm	0.55 ÷ 4.0 kW	ø35 mm
I11	651 Nm	110 mm	1.1 ÷ 4.0 kW	ø42 mm



This product is:

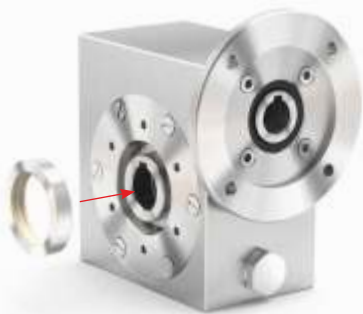

Twin viton seals with stainless steel 316L shield.



Mounting holes on both sides of the housing for versatile mounting.



Output shaft is produced in AISI 316L.
Special cover assures full protection of oil seals.



Closed protection cap in AISI 316L with o-ring.



CuSn12Ni (C91700) Nickel bronze worm gears are centrifugally cast onto an iron hub for maximum strength and superior life. removable hollow shaft with key for safe torque transmissions.



Special high tech full stainless steel housing with accurate finishing and strong rigidity.

130

21 nm

EDELSTAHL - Schneckengetriebe

Full stainless steel worm gearboxes

Input speed (n_1) = 1400 min⁻¹

Output speed n_2 [min ⁻¹]	ratio i	Motor power P_{1M} [kw]	Output torque M_{2M} [Nm]	Service factor $f.s$	Nominal power P_{1R} [kw]	Nominal torque M_{2r} [Nm]	B5 motor flanges		B14 motor flanges		Dynamic efficiency η	Tooth module m [mm]	ratios code
							-	-	-O	-p			
280	5	0.18	5	3.3	0.60	17	-	-	-O	-p	rd	1.26	01
200	7	0.18	7	2.4	0.44	17	-	-	56	63		1.44	02
140	10	0.18	10	1.8	0.32	17						1.44	03
93	15	0.18	13	1.4	0.25	19						1.44	04
70	20	0.18	17	1.1	0.20	19						1.09	05
47	30	0.12	15	1.4	0.17	21						1.44	06
35	40	0.12	19	1.1	0.13	20						1.09	07
23	61	0.09	19	1.1	0.10	20						0.72	08
17.5	80	0.06	16	1.0	0.06	16						0.56	09
14	100	0.06*	16	0.5	0.03	8						0.45	10

* Power higher than the maximum one which can be supported by the gearbox. Select according to the torque M_{2r}

Potenza superiore a quella massima sopportabile dal riduttore. Selezionare in base al momento torcente M_{2r}

Motor flanges available <i>Flange motore disponibili</i>	B) Supplied with reduction bushing <i>Fornito con bussola di riduzione</i>	B) Available on request without reduction bushing <i>Disponibile a richiesta senza bussola di riduzione</i>	C) Motor flange holes position <i>Posizione fori flangia motore</i>
---	---	--	--

Lubrication

Lubrificazione

unit 130 is supplied with synthetic oil to assure long life lubrication.

Food grade oil is available on request.

See Table 1 for lubrication and recommended quantity.

See Table 2 for possible radial and axial loads on the gearbox.

Il riduttore tipo 130 viene fornito con olio sintetico e lubrificazione tipo "long life".

Disponibile a richiesta olio alimentare.

Vedi Tabella 1 per oli e quantità consigliati.

Vedi Tabella 2 per i carichi radiali e assiali applicabili al riduttore.

Oil quantity for all positions: 0.06Lt.	Agip <i>Telium VSF 320</i>	Shell <i>Omala S4 WE 320</i>
Quantità olio per tutte le posizioni: 0.06Lt		

* For more details on lubrication and plugs check our website.

* Per maggiori dettagli su lubrificazione e tappi olio vedi il nostro sito web.

Tab. 1

radial and axial loads

Carichi radiali e assiali

Output shaft

Albero di uscita

n_2 [min ⁻¹]	F_A [n]	F_R [n]
200	120	600
150	140	700
100	160	800
75	180	900
50	200	1000
25	250	1250
15	280	1400

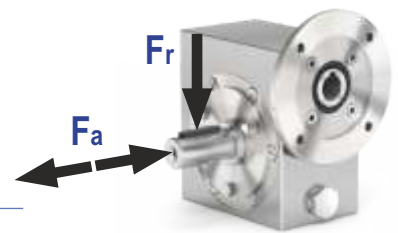

Input shaft

Albero in entrata

n_1 [min ⁻¹]	F_A [n]	F_R [n]
1400	20	100

* Strong axial loads in the DX direction are not allowed.

* Non sono consentiti forti carichi assiali con direzione DX

Tab. 2

21
nm

130

UN... PI **Basic gearbox**
Riduttore

base

Gearbox weight
peso riduttore **2.5 kg**

	Kit code	øF	A
56B14	KI304046	80	61.5
63B14	KI304045	90	62.5

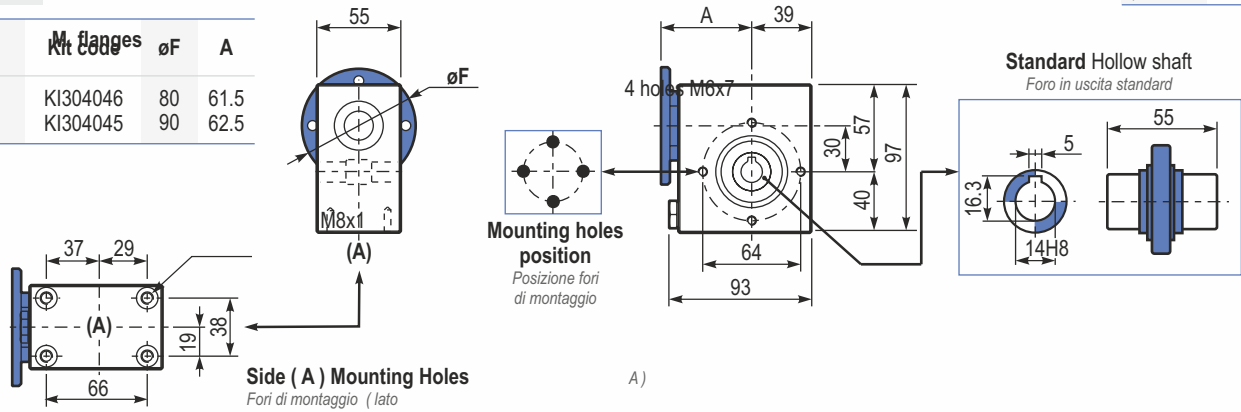

B130UN...

Modular base
Base

modulare 30

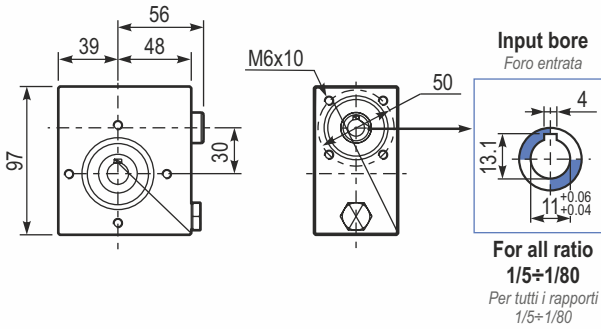

PI30FL...

Output flange
Flangia

uscita 1

kit cod. KI309011

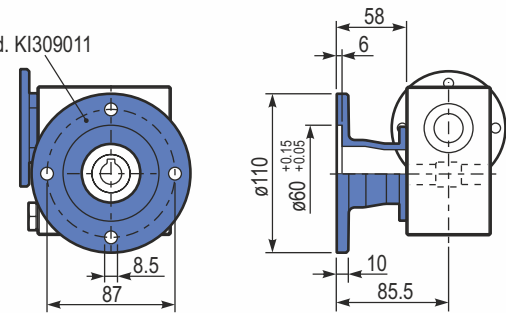

R130UN...

Input shaft
Albero

in entrata 30....

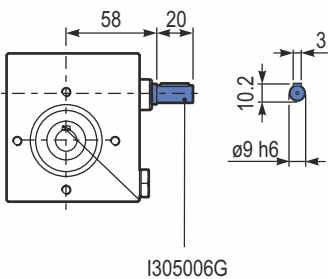

PI30BR...

Reaction arm
Braccio

di reazione

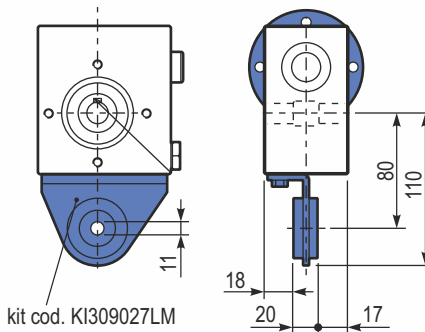

SPI...

Single Shaft
Albero

lento semplice cod. KI0305028

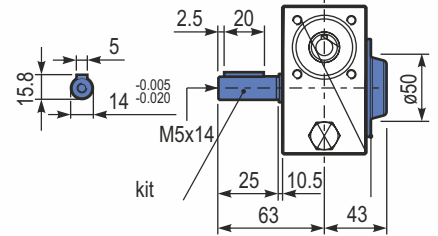

kit cod. KI450211
Protection cap (on request)
A
di protezione *richiesta coperchio*

I45

41 nm

EDELSTAHL - Schneckengetriebe

Full stainless steel worm gearboxes

Input speed (n_1) = 1400 min⁻¹

Output speed n_2 [min ⁻¹]	ratio i	Motor power p_{1M} [kw]	Output torque M_{2M} [Nm]	Service factor f.s.	Nominal power p_{1R} [kw]	Nominal torque M_{2r} [Nm]	B5 motor flanges		B14 motor flanges		Dynamic efficiency rd	Tooth module [mm]	ratios code
							-	-	-p 63	-Q 71			
200	7	0.37	14	2.2	0.80	30			B-c		80	2.2	01
140	10	0.37	20	1.5	0.57	30			B-c		79	2.2	02
100	14	0.37	27	1.1	0.41	30			B-c		77	2.4	03
67	21	0.37	36	1.2	0.43	41			B-c		67	1.6	04
50	28	0.25	31	1.3	0.33	41			B-c		65	2.5	05
38	37	0.25	40	1.0	0.26	41			B-c		63	1.8	06
30	46	0.25	46	0.9	0.22	41			B-c		59	1.6	07
23	60	0.18	41	1.0	0.18	41			B-c		56	1.2	08
20	70	0.12	31	1.0	0.12	30			B-c		54	1.0	09
13.7	102	0.12	41	0.7	0.09	29			B-c		49	0.72	10

Motor flanges available
Flange motore disponibili

B) Supplied with reduction bushing
Fornito con bussola di riduzione

B) Available on request without reduction bushing
Disponibile a richiesta senza bussola di riduzione

C) Motor flange holes position
Posizione fori flangia motore

Lubrication

Lubrificazione

unit I45 is supplied with synthetic oil to assure long life lubrication.
Food grade oil is available on request.

See Table 1 for lubrication and recommended quantity.

See Table 2 for possible radial and axial loads on the gearbox.

Il riduttore tipo I45 viene fornito con olio sintetico e lubrificazione tipo "long life".

Disponibile a richiesta olio alimentare.

Vedi Tabella 1 per oli e quantità consigliati.

Vedi Tabella 2 per i carichi radiali e assiali applicabili al riduttore.

Agip

Telium VSF 320

Shell

Omala S4 WE 320

B3

Standard
0.15 LT

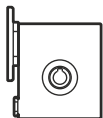

B8

On request
0.15 LT

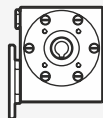

B6

On request
0.15 LT

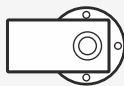

V5

On request
0.15 LT

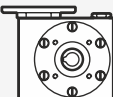

B7

On request
0.20 IT

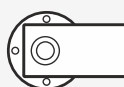

V6

On request
0.15 LT

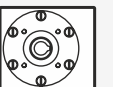

For more details on lubrication and plugs check our website.

Per maggiori dettagli su lubrificazione e tappi olio vedi il nostro sito web.

Tab. 1

radial and axial loads

Carichi radiali e assiali

Output shaft

Albero di uscita

n_2 [min ⁻¹]	F_A [n]	F_R [n]
200	180	900
150	200	1000
100	220	1100
75	240	1200
50	260	1400
25	300	1800
15	400	2000

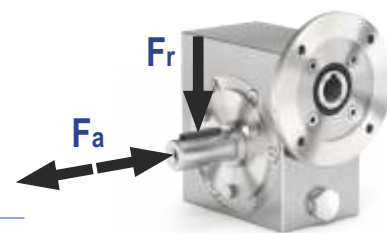

Input shaft

Albero in entrata

n_1 [min ⁻¹]	F_A [n]	F_R [n]
1400	42	210

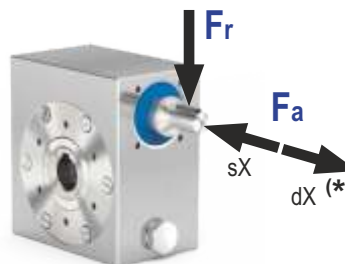

* Strong axial loads in the DX direction are not allowed.

* Non sono consentiti forti carichi assiali con direzione DX

Tab. 2

41
nm

145

UN... **PI Basic gearbox**
Riduttore

base 1

Gearbox weight
peso riduttore **5.0 kg**

M. flanges	Kit code	øF	A
63B14	KI504047	90	73.5
71B14	KI504045	105	71

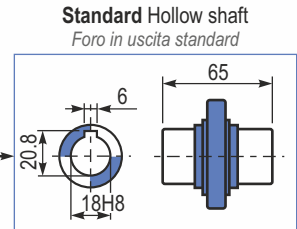
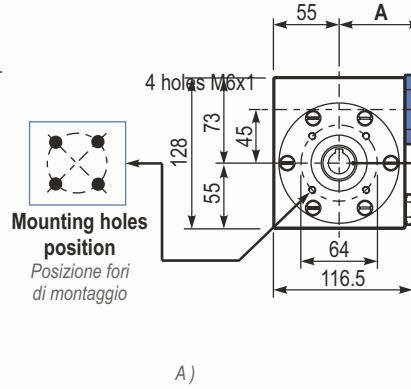
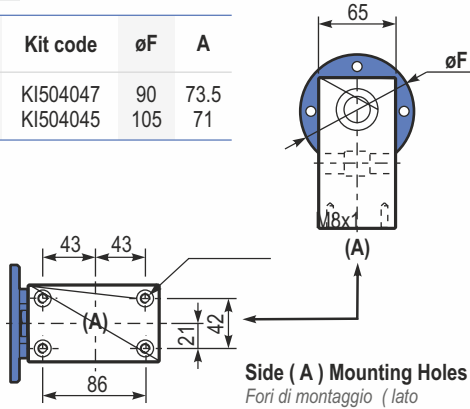

BI45UN...

Modular base
modulare 45

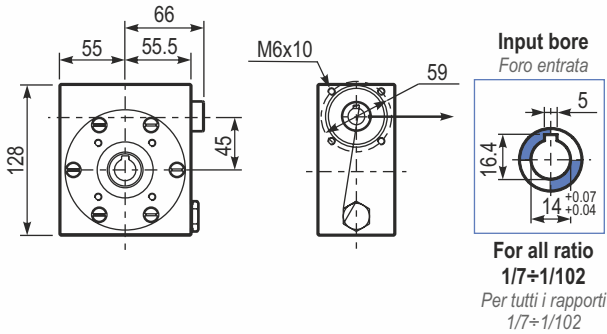

PI45FL...

Output flange
Flangia uscita 1

kit cod. KI459011

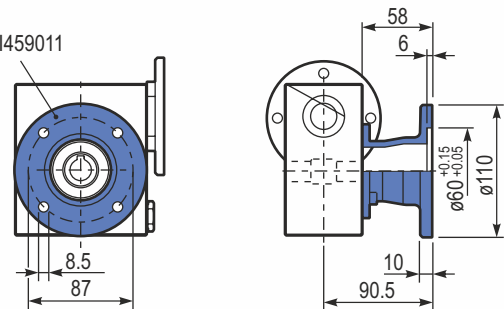

R45UN...

Input shaft
Albero in entrata 45.....

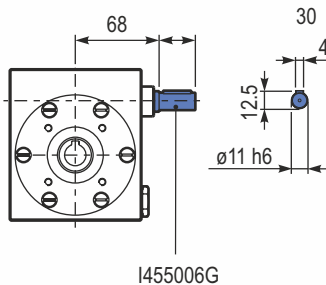

PI BR...

Reaction arm
Braccio di reazione

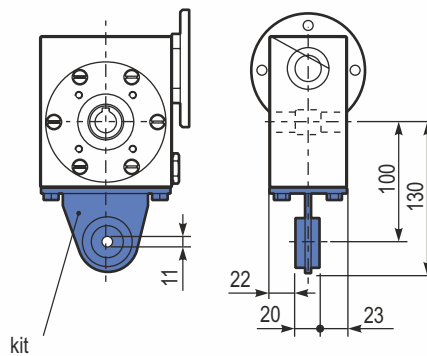

S...PI 45

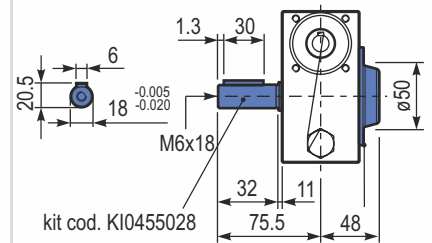

kit cod. KI450211
Protection cap
(on request) richiesta di
di protezione cod. KI459

150

72 nm

EDELSTAHL - Schneckengetriebe

Full stainless steel worm gearboxes

Input speed (n_1) = 1400 min⁻¹

Output speed n_2 [min ⁻¹]	ratio i	Motor power P_{1M} [kW]	Output torque M_{2M} [Nm]	Service factor f_s	Nominal power P_{1R} [kW]	Nominal torque M_{2r} [Nm]	B5 motor flanges			B14 motor flanges			Dynamic efficiency η	Tooth module m [mm]	ratios code
							-	-	-	-p	-Q	-r			
200	7	0.75	29	1.9	1.5	57	-	-	-	B-C	B	-	82	2.5	01
140	10	0.75	41	1.5	1.1	62	-	-	-	B-C	B	-	80	2.4	02
100	14	0.75	57	1.2	0.90	68	-	-	-	B-C	B	-	79	2.6	03
78	18	0.55	51	1.2	0.67	62	-	-	-	B-C	B	-	75	2.0	04
54	26	0.55	67	1.0	0.54	66	-	-	-	B-C	B	-	69	2.7	05
47	30	0.55	79	0.9	0.50	72	-	-	-	B-C	B	-	70	2.5	12
39	36	0.37	63	1.2	0.43	72	-	-	-	B-C	B	-	69	2.1	06
33	43	0.37	72	1.0	0.35	68	-	-	-	B-C	B	-	66	1.8	07
28	50	0.25	53	1.2	0.31	66	-	-	-	B-C	B	-	62	1.5	13
23	60	0.25	59	1.0	0.26	62	-	-	-	B-C	B	-	58	1.3	08
21	68	0.25	66	0.9	0.22	58	-	-	-	B-C	B	-	57	1.2	09
17.5	80	0.18	53	1.1	0.19	57	-	-	-	B-C	B	-	54	1.0	10
14	100	0.12	41	1.3	0.15	51	-	-	-	B-C	B	-	50	0.8	11

Motor flanges available
Flange motore disponibili

B) Supplied with reduction bushing
Fornito con bussola di riduzione

B) Available on request without reduction bushing
Disponibile a richiesta senza bussola di riduzione

C) Motor flange holes position
Posizione fori flangia motore

Lubrication

Lubrificazione

unit 150 is supplied with synthetic oil to assure long life lubrication.
Food grade oil is available on request.

See Table 1 for lubrication and recommended quantity.

See Table 2 for possible radial and axial loads on the gearbox.

Il riduttore tipo 150 viene fornito con olio sintetico e lubrificazione tipo "long life".

Disponibile a richiesta olio alimentare.

Vedi Tabella 1 per oli e quantità consigliati.

Vedi Tabella 2 per i carichi radiali e assiali applicabili al riduttore.

Agip

Tellium VSF 320

Shell

Omala S4 WE 320

B3

Standard
0.22 IT

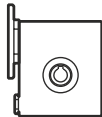

B8

On request
0.22 IT

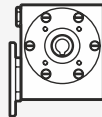

B6

On request
0.22 IT

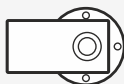

V5

On request
0.22 IT

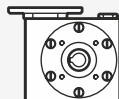

B7

On request
0.28 LT



V6

On request
0.22 IT

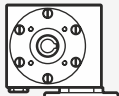

For more details on lubrication and plugs check our website.

Per maggiori dettagli su lubrificazione e tappi olio vedi il nostro sito web.

Tab. 1

radial and axial loads

Carichi radiali e assiali

Output shaft

Albero di uscita

n_2 [min ⁻¹]	F_A [n]	F_R [n]
200	240	1200
150	280	1400
100	300	1500
75	340	1700
50	380	1900
25	480	2500
15	560	2800

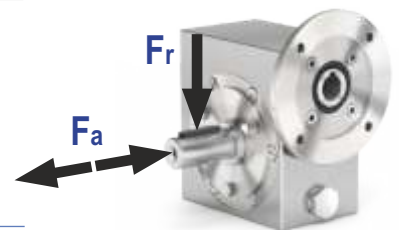

Input shaft

Albero in entrata

n_1 [min ⁻¹]	F_A [n]	F_R [n]
1400	76	380

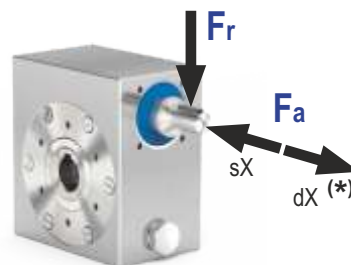

* Strong axial loads in the DX direction are not allowed.

* Non sono consentiti forti carichi assiali con direzione DX

Tab. 2

72
nm

150

UN...PI Basic gearbox
Riduttore

base

Gearbox weight
peso riduttore **7.3 kg**pd. KI500211

M. flanges	Kit code	øF	A
63B14	KI504047	90	78
71B14	KI504045	105	78
80B14	KI504046	120	76

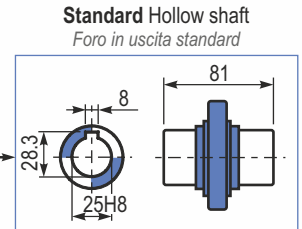
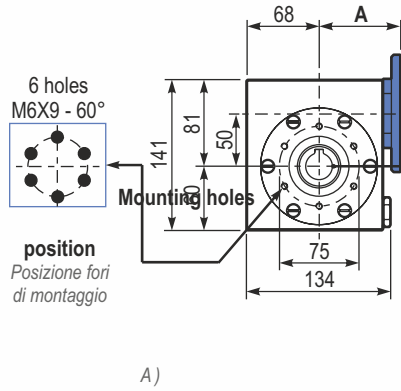
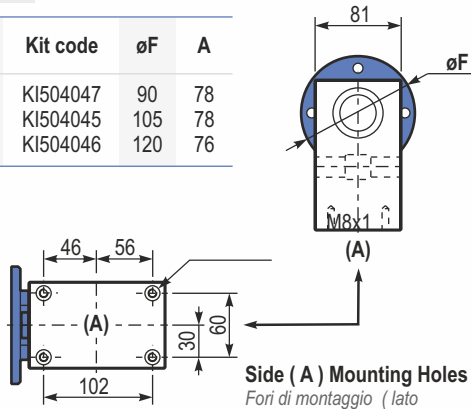

BI50UN... Modular base
Base

modulare 50

Input bore
Foro entrata

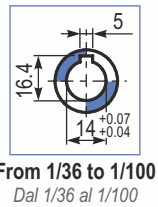
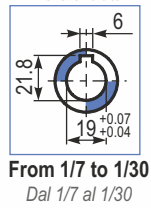
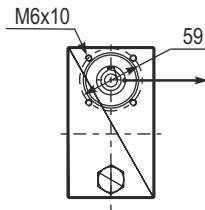
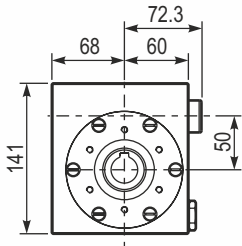

PI50FL... Output flange
Flangia

uscita 1

kit cod. KI509011

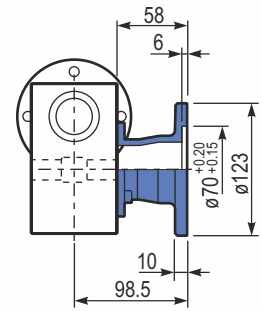
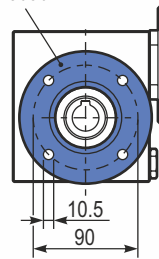

R50UN... Input shaft
Albero

in entrata 50...

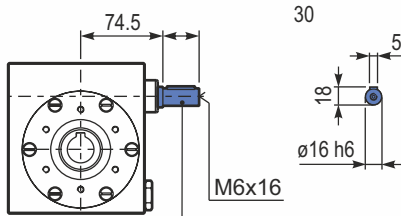

I505006G

PI BR... Reaction arm
Braccio

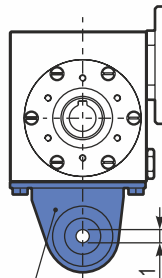

kit cod. KI509027LM

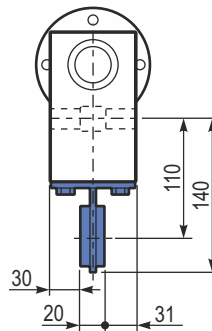

.S.P.1.50

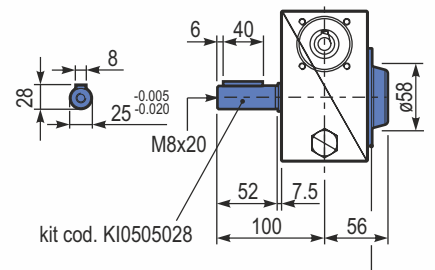

kit cod. KI505028

kit
Protection cap
(on request)
A richiesta coperchio
di protezione

I63

147 nm

EDELSTAHL - Schneckengetriebe

Full stainless steel worm gearboxes

Input speed (n_1) = 1400 min⁻¹

Output speed n_2 [min ⁻¹]	ratio i	Motor power p_{1M} [kw]	Output torque M_{2M} [Nm]	Service factor f.s	Nominal power p_{1R} [kw]	Nominal torque M_{2r} [Nm]	B5 motor flanges			B14 motor flanges			Dynamic efficiency rd	Tooth module [mm]	ratios code
							-	-	-	-Q	-r	-T			
200	7	1.8	71	1.8	3.2	125	-	-	-	71	80	90	83	3.1	01
140	10	1.8	99	1.4	2.4	134	-	-	-	71	80	90	81	3.1	02
93	15	1.5	121	1.1	1.7	138	-	-	-	71	80	90	79	3.1	03
74	19	1.1	111	1.2	1.4	138	-	-	-	71	80	90	78	2.6	04
58	24	1.1	135	1.0	1.2	142	-	-	-	71	80	90	75	2.0	05
47	30	1.1	167	0.9	0.96	146	-	-	-	71	80	90	74	3.2	06
39	36	0.75	125	1.2	0.88	147	-	-	-	71	80	90	68	2.7	07
35	40	0.75	135	1.0	0.78	140	-	-	-	71	80	90	66	2.5	13
31	45	0.55	111	1.2	0.67	135	-	-	-	71	80	90	66	2.1	08
23	60	0.55	140	0.9	0.51	130	-	-	-	71	80	90	62	1.6	12
21	67	0.55	151	0.8	0.45	124	-	-	-	71	80	90	60	1.5	09
17.5	80	0.37	115	1.0	0.38	119	-	-	-	71	80	90	57	1.3	10
14.9	94	0.37	123	1.0	0.36	119	-	-	-	71	80	90	52	1.1	11

Motor flanges available
Flange motore disponibili



B) Supplied with reduction bushing
Fornito con bussola di riduzione



B) Available on request without reduction bushing
Disponibile a richiesta senza bussola di riduzione



C) Motor flange holes position
Posizione fori flangia motore

Lubrication

Lubrificazione

unit I63 is supplied with synthetic oil to assure long life lubrication.
Food grade oil is available on request.

See Table 1 for lubrication and recommended quantity.

See Table 2 for possible radial and axial loads on the gearbox.

Il riduttore tipo I63 viene fornito con olio sintetico e lubrificazione tipo "long life".

Disponibile a richiesta olio alimentare.

Vedi Tabella 1 per oli e quantità consigliati.

Vedi Tabella 2 per i carichi radiali e assiali applicabili al riduttore.

Agip

Telium VSF 320

Shell

Omala S4 WE 320

B3

Standard
0.60 IT

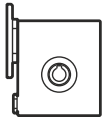

B8

On request
0.60 IT

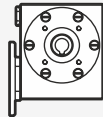

B6

On request
0.60 IT

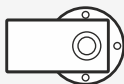

V5

On request
0.60 IT

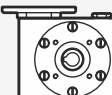

B7

On request
0.82 LT

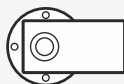

V6

On request
0.60 IT

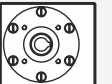

For more details on lubrication and plugs check our website.

Per maggiori dettagli su lubrificazione e tappi olio vedi il nostro sito web.

Tab. 1

radial and axial loads

Carichi radiali e assiali

Output shaft

Albero di uscita

n_2 [min ⁻¹]	F_A [n]	F_R [n]
200	360	1800
150	400	2000
100	460	2300
75	500	2500
50	600	3000
25	700	3800
15	800	4000

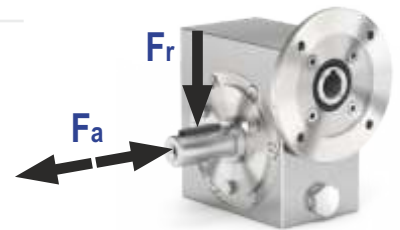

Input shaft

Albero in entrata

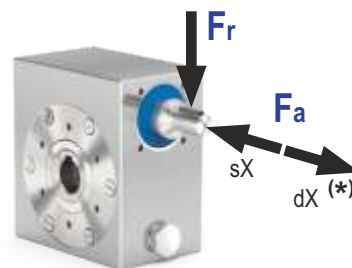

n_1 [min ⁻¹]	F_A [n]	F_R [n]
1400	90	450

* Strong axial loads in the DX direction are not allowed.

* Non sono consentiti forti carichi assiali con direzione DX

Tab. 2

147
nm

163

UN...

Basic gearbox
Riduttore

base

PI

Gearbox weight
peso riduttore 14.6 kg

M. flanges	Kit code	øF	A
71B14	KI634047	105	97
80B14	KI634046	120	99
90B14	KI634041	140	99

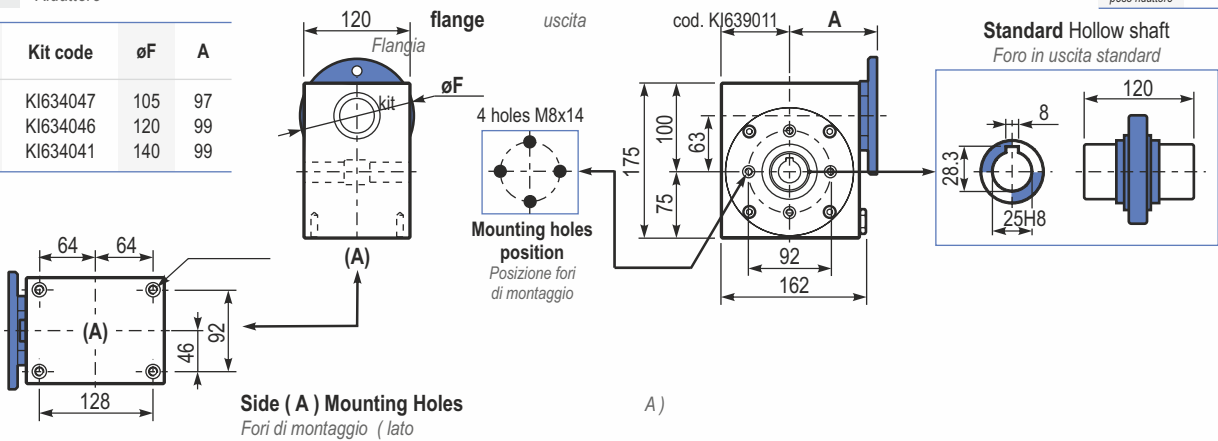

B163UN...

Modular

Input bore
base

base

modulare

Output

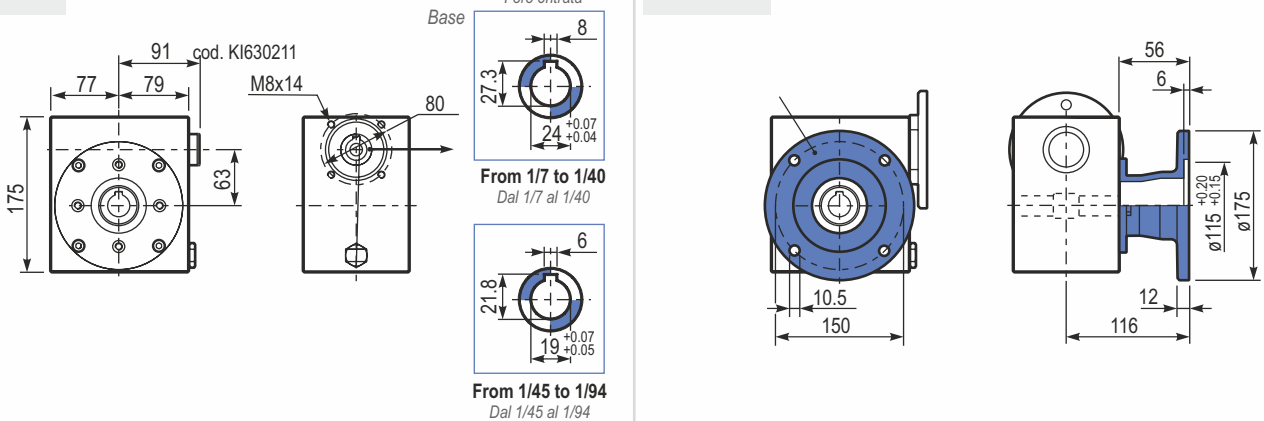

PI BR... Reaction arm
Braccio

arm di reazione

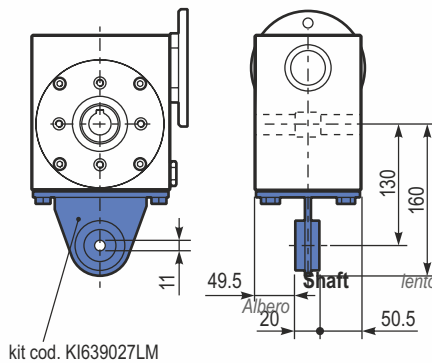
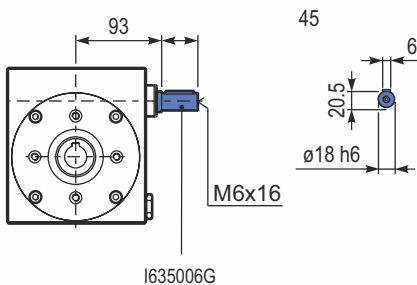

S... Single
63

kit
Protection cap (on request)
A richiesta coperchio di protezione

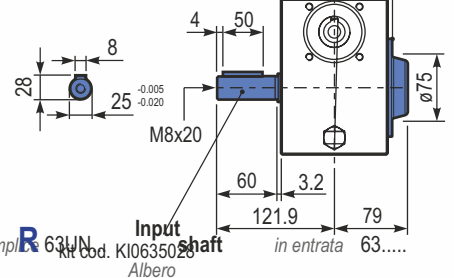

Edelstahl

185

347 Nm

EDELSTAHL - Schneckengetriebe

Full stainless steel worm gearboxes

Input speed (n_1) = 1400 min⁻¹

Output speed n_2 [min ⁻¹]	Ratio i	Motor power P_{1M} [kW]	Output torque M_{2M} [Nm]	Service factor f.s	Nominal power P_{1R} [kW]	Nominal torque M_{2R} [Nm]	B5 motor flanges			B14 motor flanges			Dynamic efficiency RD	Tooth module [mm]	Ratios code
							-	-	--U -	-R	-T				
200	7	4.0	168	1.5	6.1	257				B	B		88	4.23	01
140	10	4.0	218	1.3	5.2	284				B	B		80	4.2	02
100	14	3.0	223	1.4	4.1	305				B	B		78	4.5	03
70	20	2.2	237	1.2	2.7	294				B	B		79	3.4	04
64	22	2.2	258	1.1	2.5	294				B	B		78	3.1	05
50	28	2.2	315	1.1	2.4	347				B	B		75	4.7	06
37	38	1.5	276	1.2	1.8	336				B			71	3.5	07
30	46	1.5	320	1.0	1.5	326				B			68	3.1	08
27	52	1.1	258	1.1	1.2	289				B			66	2.7	09
21	67	1.1	327	0.9	0.97	289				B			65	2.1	10
18.9	74	0.75	220	1.2	0.91	268				B			58	1.9	11
14.6	96	0.55	191	1.3	0.70	242				B			53	1.5	12

Motor flanges available
Flange motore disponibili

B) Supplied with reduction bushing
Fornito con bussola di riduzione

B) Available on request without reduction bushing
Disponibile a richiesta senza bussola di riduzione

C) Motor flange holes position
Posizione fori flangia motore

Lubrication

Lubrificazione

Unit I85 is supplied with synthetic oil to assure long life lubrication.
Food grade oil is available on request.

See Table 1 for lubrication and recommended quantity.

See Table 2 for possible radial and axial loads on the gearbox.

Il riduttore tipo I85 viene fornito con olio sintetico e lubrificazione tipo "long life".

Disponibile a richiesta olio alimentare.

Vedi Tabella 1 per oli e quantità consigliati.

Vedi Tabella 2 per i carichi radiali e assiali applicabili al riduttore.

Agip

Telium VSF 320

Shell

Omala S4 WE 320

B3
Standard
1.40 LT

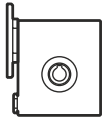

B8
On request
1.40 LT

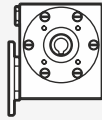

B6
On request
1.40 LT

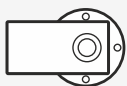

V5
On request
1.40 LT

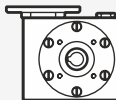

B7
On request
1.70 LT

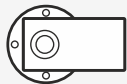

V6
On request
1.40 LT

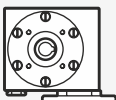

For more details on lubrication and plugs check our website.

Per maggiori dettagli su lubrificazione e tappi olio vedi il nostro sito web.

Tab. 1

Radial and axial loads

Carichi radiali e assiali

Output shaft

Albero di uscita

n_2 [min ⁻¹]	F_A [N]	F_R [N]
200	500	2500
150	580	2900
100	600	3000
75	700	3500
50	800	4000
25	1000	5000
15	1160	5800

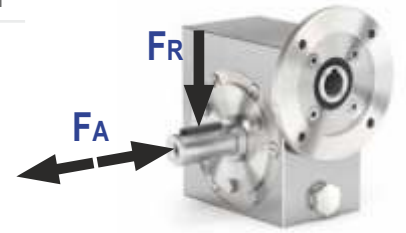

Input shaft

Albero in entrata

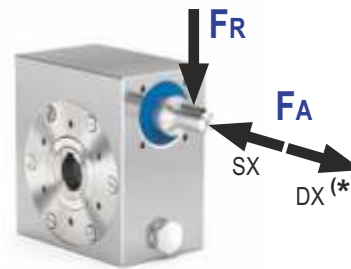

n_1 [min ⁻¹]	F_A [N]	F_R [N]
1400	130	650

* Strong axial loads in the DX direction are not allowed.

* Non sono consentiti forti carichi assiali con direzione DX

Tab. 2

347
Nm

185

Gearbox weight
peso riduttore **23.3 kg**

PI85UN... **Basic gearbox**
Riduttore base

M. flanges	Kit code	øF	A
80B14	KI854046	120	118
90B14	KI854045	140	118
100-112B14	KI854041	160	127

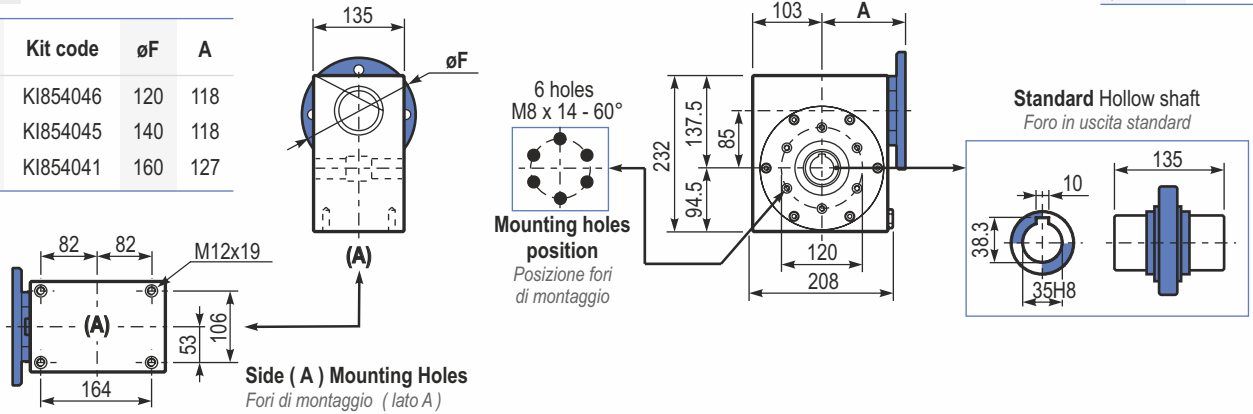

BI85UN... **Modular base**
Base modulare

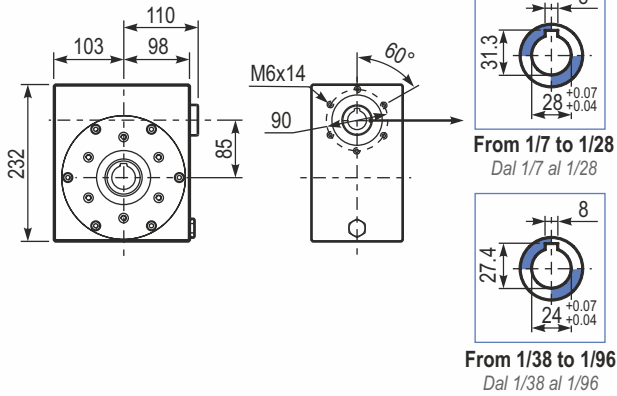

PI85FL... **Output flange**
Flangia uscita

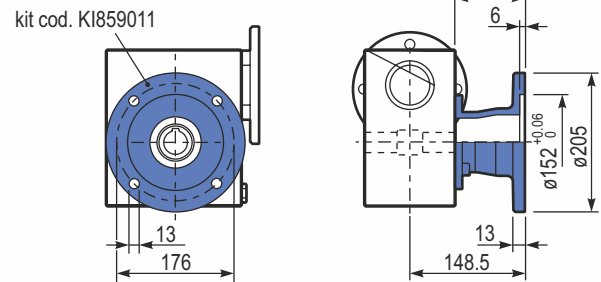

RI85UN... **Input shaft**
Albero in entrata

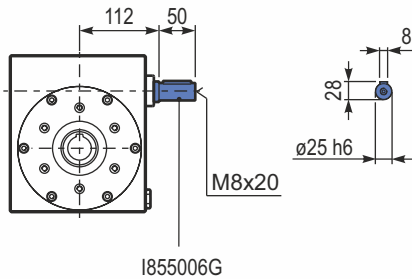

PI85BR... **Reaction arm**
Braccio di reazione

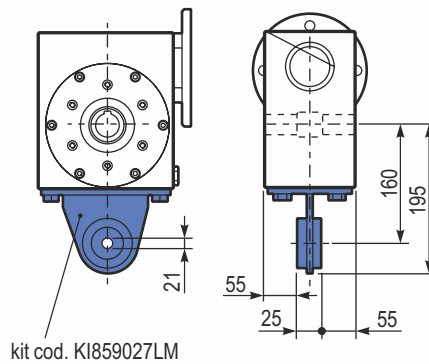

PI85.....S... **Single Shaft**
Albero lento semplice

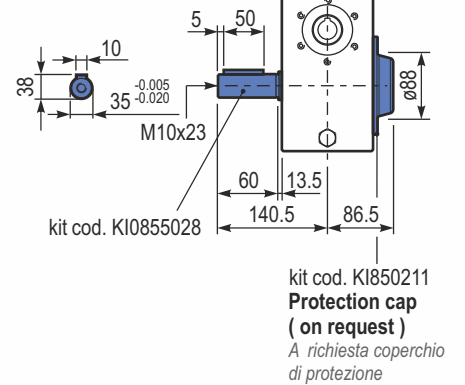

I11

651 Nm

EDELSTAHL - Schneckengetriebe

Full stainless steel worm gearboxes

Input speed (n_1) = 1400 min⁻¹

Output speed n_2 [min ⁻¹]	Ratio i	Motor power P_{1M} [kW]	Output torque M_{2M} [Nm]	Service factor f.s	Nominal power P_{1R} [kW]	Nominal torque M_{2R} [Nm]	B5 motor flanges			B14 motor flanges			Dynamic efficiency RD	Tooth module [mm]	Ratios code
							-	-	-	-R	-T	-U			
200	7	4.0	168	2.9	11.5	483	-	-	-	B	B		88	5.5	01
140	10	4.0	235	2.2	9.0	525	-	-	-	B	B		86	5.4	02
88	16	4.0	358	1.5	6.0	536	-	-	-	B	B		82	5.3	03
70	20	4.0	447	1.2	4.9	546	-	-	-	B	B		82	4.5	04
61	23	3.0	377	1.4	4.1	515	-	-	-	B	B		80	3.9	05
47	30	3.0	467	1.4	4.2	651	-	-	-	B	B		76	5.6	06
37	38	3.0	583	1.1	3.3	641	-	-	-	B	B		75	4.7	07
31	45	2.2	493	1.2	2.7	599	-	-	-	B	B		73	4.0	08
26	53	2.2	557	1.1	2.5	620	-	-	-	B	B		70	3.5	09
22	64	1.5	452	1.2	1.8	536	-	-	-	B	B		69	2.9	10
16.7	84	1.1	410	1.2	1.3	494	-	-	-	B	B		65	2.2	11
14.1	99	1.1	446	1.1	1.2	483	-	-	-	B	B		60	1.9	12

Motor flanges available
Flange motore disponibili

B) Supplied with reduction bushing
Fornito con bussola di riduzione

B) Available on request without reduction bushing
Disponibile a richiesta senza bussola di riduzione

C) Motor flange holes position
Posizione fori flangia motore

Lubrication

Lubrificazione

Unit I11 is supplied with synthetic oil to assure long life lubrication. Food grade oil is available on request.

See Table 1 for lubrication and recommended quantity.

See Table 2 for possible radial and axial loads on the gearbox.

Il riduttore tipo I11 viene fornito con olio sintetico e lubrificazione tipo "long life".

Disponibile a richiesta olio alimentare.

Vedi Tabella 1 per oli e quantità consigliati.

Vedi Tabella 2 per i carichi radiali e assiali applicabili al riduttore.

Agip Telium VSF 320
Shell Omala S4 WE 320

B3
Standard
3.50 LT

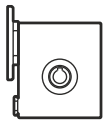

B8
On request
2.10 LT

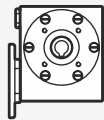

B6
On request
2.50 LT

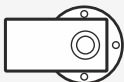

V5
On request
1.60 LT

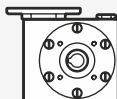

B7
On request
2.50 LT



V6
On request
1.60 LT

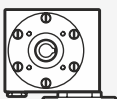

For more details on lubrication and plugs check our website.
Per maggiori dettagli su lubrificazione e tappi olio vedi il nostro sito web.

Tab. 1

Radial and axial loads

Carichi radiali e assiali

Output shaft

Albero di uscita

n_2 [min ⁻¹]	F_A [N]	F_R [N]
200	600	2900
150	700	3300
100	750	3600
75	800	4000
50	920	4600
25	1200	6000
15	1400	7000

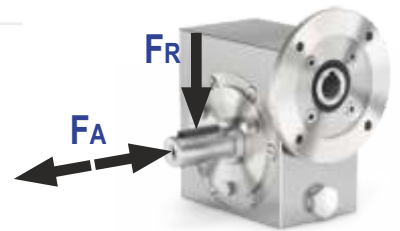

Input shaft

Albero in entrata

n_1 [min ⁻¹]	F_A [N]	F_R [N]
1400	228	1140

* Strong axial loads in the DX direction are not allowed.
* Non sono consentiti forti carichi assiali con direzione DX

Tab. 2

651 Nm

111

Gearbox weight
peso riduttore 38.5 kg

PI11UN... Basic gearbox
Riduttore base

M. flanges	Kit code	øF	A
80B14	KI854046	120	137.5
90B14	KI854045	140	137.5
100-112B14	KI854041	160	146.5

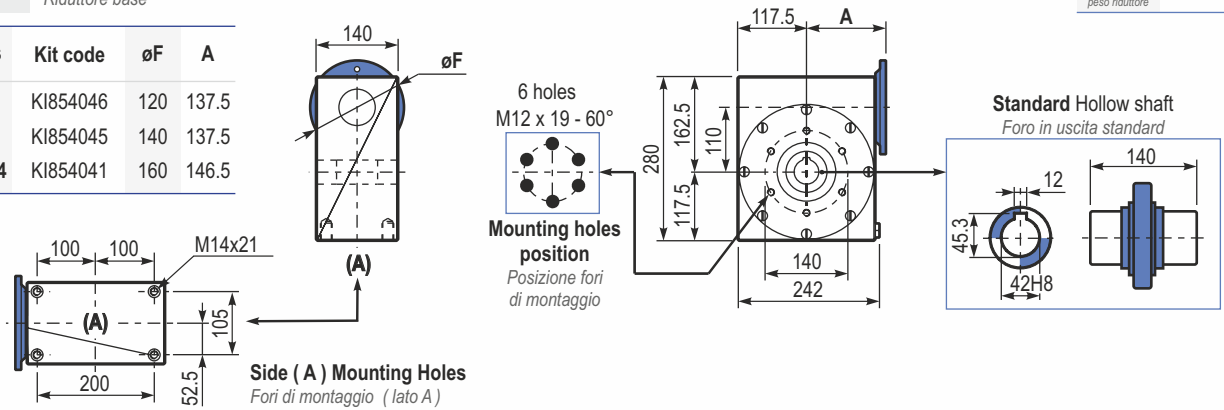

Side (A) Mounting Holes
Fori di montaggio (lato A)

BI11UN... Modular base
Base modulare

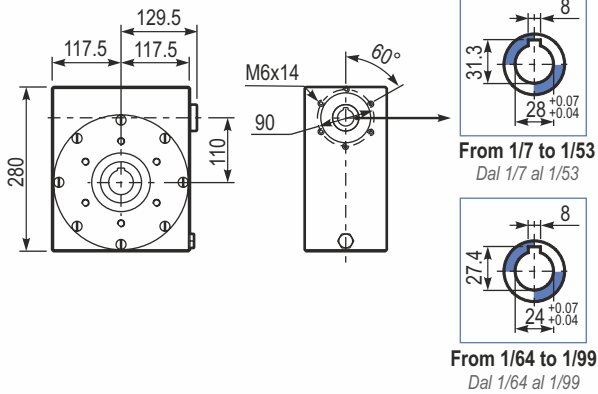

PI11BR... Reaction arm
Braccio di reazione

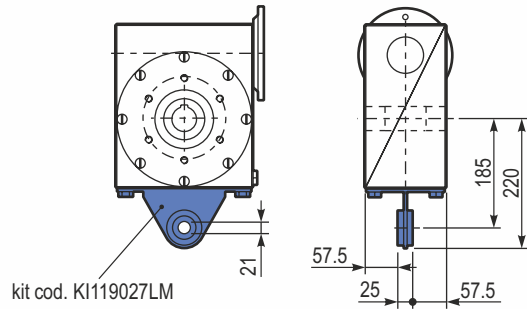

RI11UN... Input shaft
Albero in entrata

