

EDELSTAHL - Koaxialgetriebe

stainless steel shielded coaxial gearboxes

This range is   certified



EDELSTAHL - Koaxialgetriebe

Stainless steel shielded coaxial gearboxes

Type <i>Tipo</i>	Torque <i>Coppia</i>	Center distance <i>Interasse</i>	Input power <i>Potenza in entrata</i>	Hollow output shaft <i>Albero cavo in uscita</i>
402L	160 Nm	-	0.37 ÷ 1.5 kW	ø25 mm
602L	520 Nm	-	1.1 ÷ 4.0 kW	ø35 mm



This product is:



The "L" series is an already totally enclosed aluminum gearboxes, that is shielded and sealed by stainless steel 316L case.



Output shaft is produced in alsI 316L.



Fully modular IEC flanges and compact NEMA C motor flanges.



Standard FPM (FKM) seals.



Hardened and ground gears.

402L

160 Nm

EDELSTAHL - Koaxialgetriebe

Stainless steel shielded coaxial gearboxes

The dynamic efficiency is

Input speed (n_1) = 1400 min⁻¹

Output speed n_2 [min ⁻¹]	Ratio i	Motor power P_{1M} [kW]	Output torque M_{2M} [Nm]	Service factor $f.s.$	Nominal power P_{1R} [kW]	Nominal torque M_{2R} [Nm]	B5 motor flanges		B14 motor flanges			Output shaft 	Ratio code
							-	-	-Q 71	-R 80	-T 90		
398	3.52	1.5	34	2.3	3.5	80			C	C		2821	01
321	4.37	1.5	43	2.1	3.1	90			C	C		2848	02
252	5.56	1.5	54	1.8	2.7	100			C	C		2813	03
220	6.36	1.5	62	1.5	2.3	95			C	C		1921	04
191	7.33	1.5	72	1.7	2.5	120			C	C		2812	05
177	7.89	1.5	77	1.6	2.3	120			C	C		1918	06
139	10.06	1.5	99	1.5	2.3	150			C	C		1913	08
120	11.66	1.5	114	1.5	2.3	174			C	C		1713	09
106	13.26	1.5	130	1.2	1.8	160			C	C		1912	10
102	13.68	1.5	134	1.1	1.6	144			C	C		1513	25
91	15.37	1.5	151	1.1	1.6	160			C	C		1712	11
86	16.20	1.5	159	0.9	1.3	138			C	C		1910	12
78	18.04	1.5	177	0.9	1.4	160			C	C		1512	23
75	18.78	1.1	134	1.0	1.1	138			C	C		1710	24
65	21.54	1.1	154	1.0	1.1	160			C	C		1312	14
63	22.29	1.1	160	1.0	1.1	167			C	C		1013	15
53	26.31	0.75	129	1.1	0.80	138			C	C		1310	16
47.6	29.40	0.75	144	1.1	0.83	160			C	C		1012	17
39	35.91	0.55	130	1.1	0.59	138			C	C		1010	18
36.5	38.37	0.55	139	1.2	0.64	160			C	C		912	19
29.9	46.87	0.55	170	0.8	0.45	138			C	C		910	20
27.6	50.67	0.37	123	1.1	0.40	132			C	C		712	21
22.6	61.89	0.37	150	0.9	0.34	138			C	C		710	22

Motor flanges available
Flange motore disponibili

 B) Fornito con bussola di riduzione

B) Available on request without reduction bushing
Disponibile a richiesta senza bussola di riduzione

 C) Motor flange holes position
Posizione fori flangia motore

Lubrication

Lubrificazione

Always specify the mounting position
Specificare sempre la posizione di montaggio

Unit 402L is supplied with synthetic oil to assure long life lubrication.
Food grade oil is available on request.

See Table 1 for lubrication and recommended quantity.





See Table 2 for possible radial and axial loads on the gearbox.

Il riduttore tipo 402L viene fornito con olio sintetico e lubrificazione tipo "long life".

Disponibile a richiesta olio alimentare.

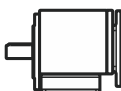
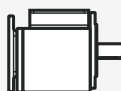
Vedi Tabella 1 per oli e quantità consigliati.

Vedi Tabella 2 per i carichi radiali e assiali applicabili al riduttore.

Agip	Shell	V8	
Telium VSF 320	Omala S4 WE 320	On request ASK	
B3		B8	
Standard 0.25 LT		On request 0.40 LT	
B6		V5	
On request 0.30 LT		On request 0.40 LT	
B7		V6	
On request 0.40 LT		On request 0.50 LT	

0.96 for all ratios

Tab. 1

Radial and axial loads

Carichi radiali e assiali

Output shaft

Albero di uscita

n_2 [min ⁻¹]	F_A [N]	F_R [N] $X + 21$
300	310	1550
250	330	1650
200	360	1800
140	406	2030
120	448	2240
85	480	2400
70	540	2700
40	600	3000
15	600	3000

$$F_{eq} = F_R \cdot \frac{51}{X}$$

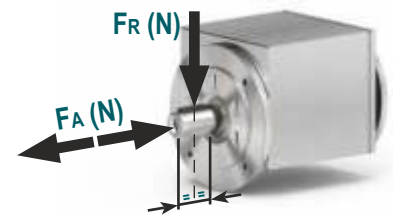
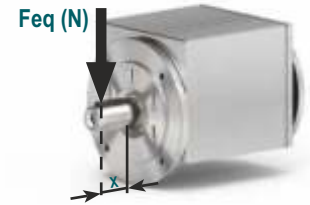

Tab. 2

160
Nm

402L

P402L-F.. Basic gearbox
Riduttore base

Gearbox weight 9.2 kg
Peso riduttore

M. flanges	Kit code	øF	k1
71B14	KI634047	105	179.5
80B14	KI634046	120	180.5
90B14	KI634041	140	181.5

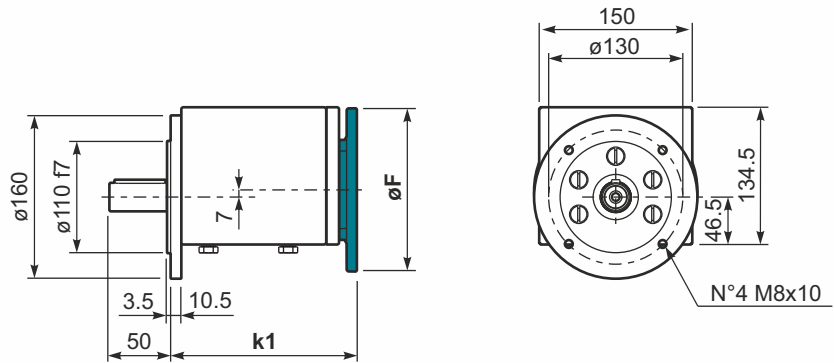

P402LH1.. Feet
Piedini

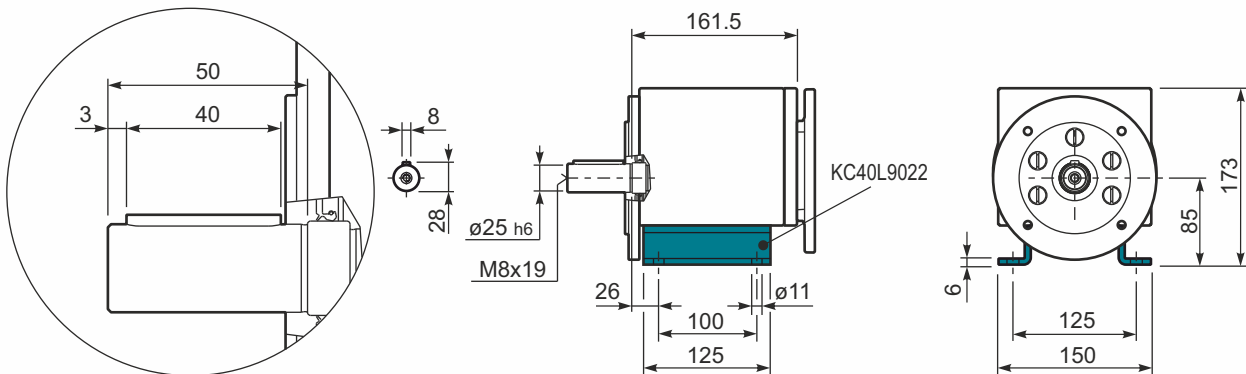

P402L-F.. Basic gearbox
Riduttore base

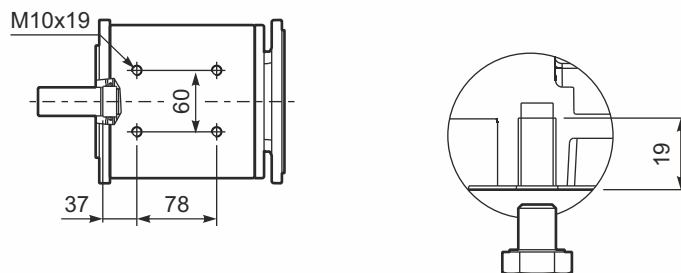

For direct mounting
of the gearboxes
remove the 4 screws
Per un montaggio diretto
con il riduttore rimuovere le 4 viti